

Home  
Search Properties  
Marketing Strategies  
Landowner Resources

es

ce

County

County

Select All

- Angelina Co., TX
- Aransas Co., TX
- Atascosa Co., TX
- Austin Co., TX
- Bandera Co., TX
- Bastrop Co., TX
- Bee Co., TX
- Bell Co., TX
- Bexar Co., TX
- Blanco Co., TX
- Brazos Co., TX
- Brewster Co., TX
- Brooks Co., TX
- Brown Co., TX
- Burleson Co., TX
- Burnet Co., TX
- Caldwell Co., TX
- Calhoun Co., TX
- Cameron Co., TX
- Camp Co., TX
- Cass Co., TX
- Coleman Co., TX
- Collin Co., TX
- Colorado Co., TX
- Comal Co., TX
- Comanche Co., TX
- Coryell Co., TX
- Crockett Co., TX
- De Witt Co., TX
- Denton Co., TX
- Dimmit Co., TX
- Duval Co., TX
- Ector Co., TX
- Edwards Co., TX
- Fayette Co., TX
- Frio Co., TX
- Gaines Co., TX
- Galveston Co., TX
- Gillespie Co., TX
- Gonzales Co., TX
- Grimes Co., TX

# ONVERSE



# 709 JANICE LN CONVERSE TX

\$88,000 | BEXAR COUNTY, TX 78109

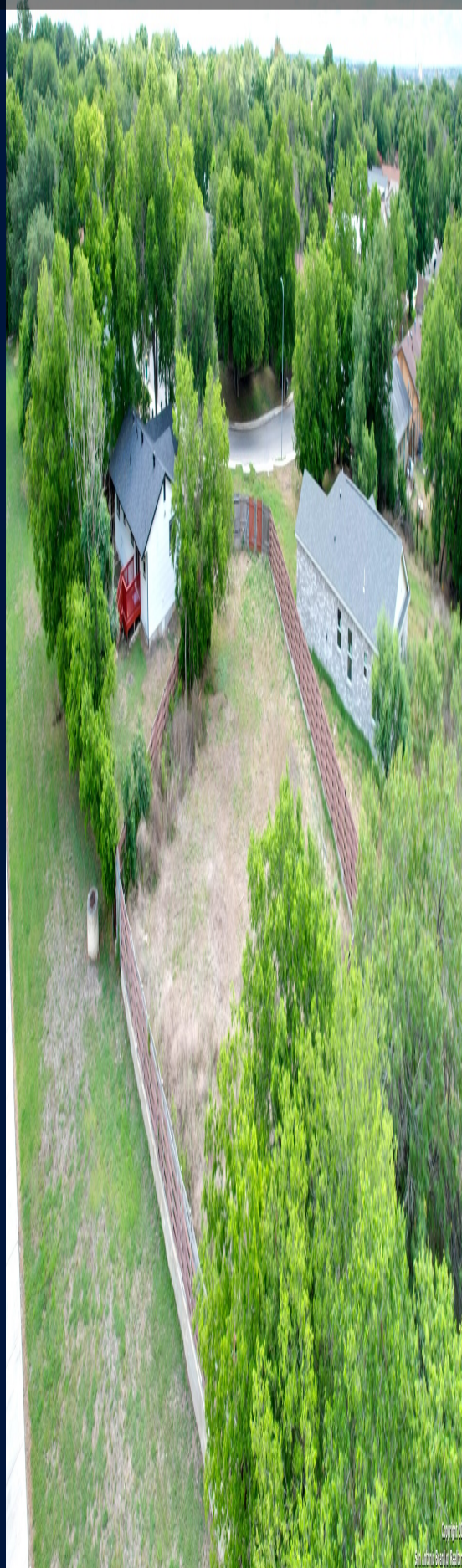



# 709 JANICE LN CONVERSE TX

\$88,000 | BEXAR COUNTY, TX 78109



# 709 JANICE LN CONVERSE TX

\$88,000 | BEXAR COUNTY, TX 78109





# 709 JANICE LN CONVERSE TX

\$88,000 | BEXAR COUNTY, TX 78109





# 709 JANICE LN CONVERSE TX

\$88,000 | BEXAR COUNTY, TX 78109



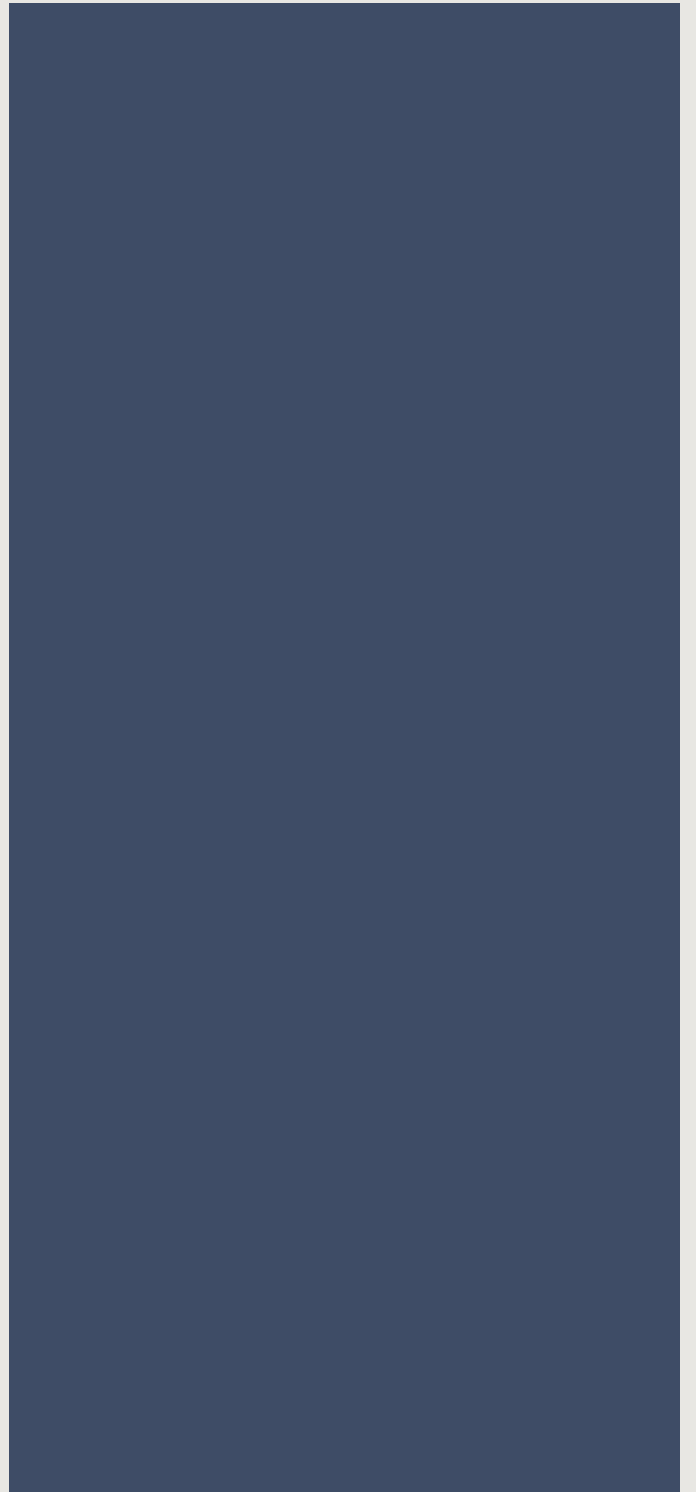

While this is not our property, we are able to represent you as a buyer and would love to set up a showing for you.

---

# PROPERTY DETAILS

Status:Available

Type:undeveloped-land

MLS #:1788750

# PROPERTY DESCRIPTION

This lot will not last. Build your Dream Home on this beautiful flat lot in a very nice established neighborhood. 0.169 acre with a green belt. Close to all the major highways . Rolling oaks mall on 1604 and The Forum shopping center on the I-35 Corridor. Bring your plans. Seller has install a very durable fence 6 ft deep and 8 ft tall metal poles and 3.6 ft deep and 8 ft tall on all sides of the fence. Fence will last for a really long time.

# COMMUNITY INFORMATION

Address:709 JANICE LN Converse, TX 78109

County:Bexar

City:Converse

Subdivision:QUAIL RIDGE

Zip Code:78109

# SCHOOL INFORMATION

School System:Judson

High School:Judson

Middle School:Judson Middle School

Elementary School:Millers Point

# PROPERTY FEATURES

Lot Size:0 Acres

Lot Improvements:Paved Roads

Location:In Subdivision



Restrictions:Building

Trees:None

Site/Area Features:None

Topography:Level

Utilities on Site:None

Frontage:City Street

# TAX AND FINANCIAL INFO

Proposed Terms:Conventional,Cash

Total Tax:1351.74







# PROPERTIES YOU MAY BE INTERESTED IN

---

*Sutton County, TX \$28,950,00011610.00 Acres*

---

*Blanco County, TX \$21,500,000844.00 Acres*

---

*Real County, TX \$19,950,0004365.00 Acres*

---

*Frio County, TX \$18,800,0002373.00 Acres*

# FREE PROPERTY EVALUATION

Name

 First

Phone

Email

County

[Get Your Free Evaluation »](#)

Δ







SABOR.com  
SAN ANTONIO BOARD OF REALTORS





This Business is Regulated by the  
Texas Real Estate Commission

**CALL**





