

Home  
Search Properties  
Marketing Strategies  
Landowner Resources

es

County  
County  
Select All

- Angelina Co., TX
- Aransas Co., TX
- Atascosa Co., TX
- Austin Co., TX
- Bandera Co., TX
- Bastrop Co., TX
- Bee Co., TX
- Bell Co., TX
- Bexar Co., TX
- Blanco Co., TX
- Brazos Co., TX
- Brewster Co., TX
- Brooks Co., TX
- Brown Co., TX
- Burleson Co., TX
- Burnet Co., TX
- Caldwell Co., TX
- Calhoun Co., TX
- Cameron Co., TX
- Camp Co., TX
- Cass Co., TX
- Coleman Co., TX
- Collin Co., TX
- Colorado Co., TX
- Comal Co., TX
- Comanche Co., TX
- Coryell Co., TX
- Crockett Co., TX
- De Witt Co., TX
- Denton Co., TX
- Dimmit Co., TX
- Duval Co., TX
- Ector Co., TX
- Edwards Co., TX
- Fayette Co., TX
- Frio Co., TX
- Gaines Co., TX
- Galveston Co., TX
- Gillespie Co., TX
- Gonzales Co., TX
- Grimes Co., TX

# ROSEMARY E TX

78163

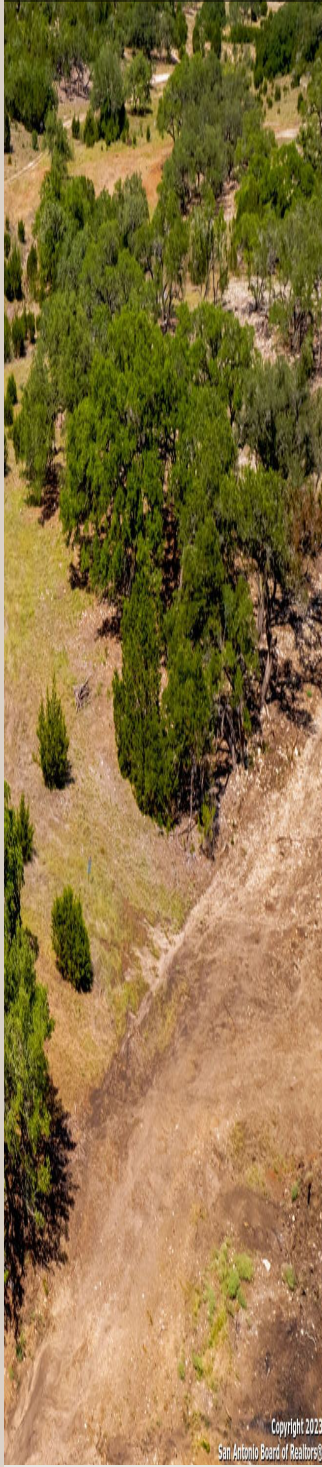

# LOT 11 – 616 ROSEMARY RIDGE BULVERDE TX

\$239,000 | 1 ACRES | COMAL COUNTY, TX 78163





# LOT 11 – 616 ROSEMARY RIDGE BULVERDE TX

\$239,000 | 1 ACRES | COMAL COUNTY, TX 78163





# LOT 11 – 616 ROSEMARY RIDGE BULVERDE TX

\$239,000 | 1 ACRES | COMAL COUNTY, TX 78163

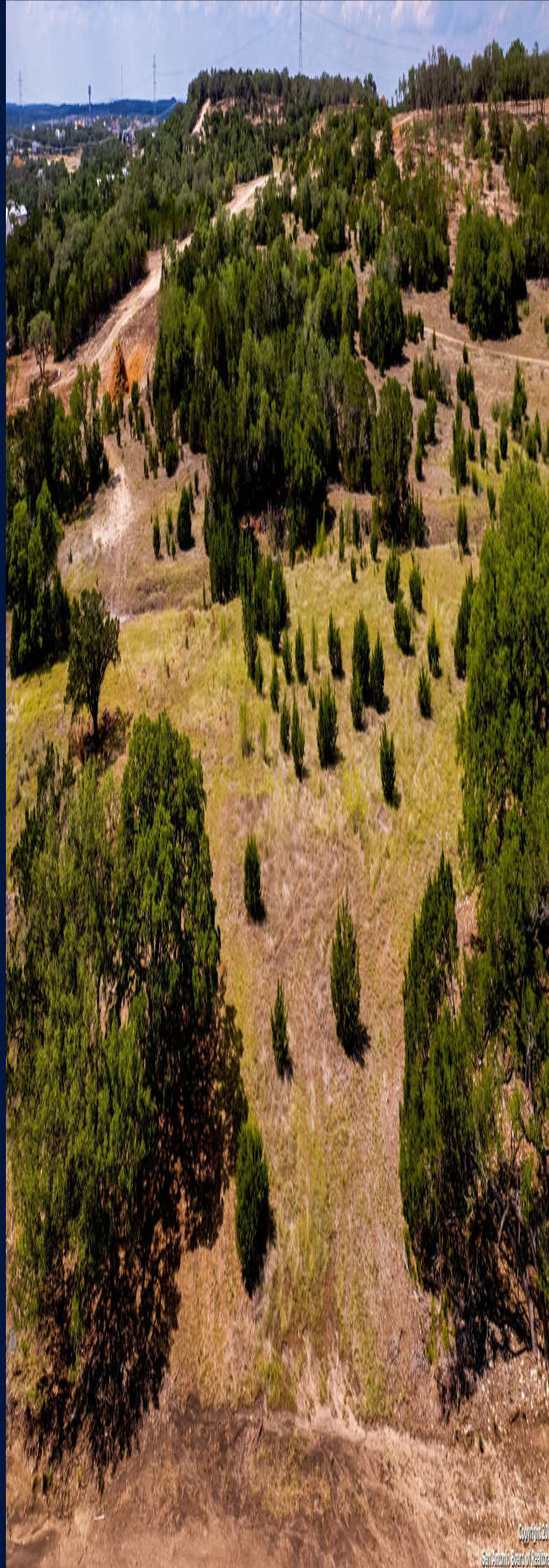



# LOT 11 – 616 ROSEMARY RIDGE BULVERDE TX

\$239,000 | 1 ACRES | COMAL COUNTY, TX 78163



# LOT 11 – 616 ROSEMARY RIDGE BULVERDE TX

\$239,000 | 1 ACRES | COMAL COUNTY, TX 78163





# LOT 11 – 616 ROSEMARY RIDGE BULVERDE TX

\$239,000 | 1 ACRES | COMAL COUNTY, TX 78163





# LOT 11 - 616 ROSEMARY RIDGE BULVERDE TX

\$239,000 | 1 ACRES | COMAL COUNTY, TX 78163







Name

First

Phone

Email

Untitled

Financing Info

Contact me with financing info about  
 this property

Periodically receive

Yes, I'd like to periodically receive  
information about the land market

Submit

△



While this is not our property, we are able to represent you as a buyer and would love to set up a showing for you.

# PROPERTY DETAILS

Status:Available

Type:undeveloped-land

MLS #:1722398

Lot Size:1

# PROPERTY DESCRIPTION

Escape to the serene beauty of the Texas Hill Country with this exceptional 1-acre residential lot in the prestigious Belle Oaks neighborhood. Nestled in a tranquil and private community, this property offers the perfect canvas for your dream home. Imagine waking up every morning to the stunning vistas of the rolling hills, abundant oak trees, and the natural splendor of the Texas landscape. Lot purchase includes CAD drawings of 3400 square foot home to be built, which you can edit to personalize. Property Highlights include 1 acre of prime real estate, providing ample space for your custom-built home and outdoor amenities. This specific lot is flat, easily buildable, and offers building locations where you limit the view of any other home, truly making your dream home a private oasis. Belle Oaks neighborhood is known for its spacious lots and a sense of seclusion, providing you with the privacy you desire. All necessary utilities, including water, electricity, and gas, are available for easy connection. Residents of Belle Oaks have access to exclusive amenities such as a community pool, clubhouse, and walking trails. Situated in the heart of the Texas Hill Country, Belle Oaks is conveniently located near shops, restaurants, and recreational activities. It's also within a short drive to San Antonio and the bustling city life. Explore the charm of the Texas Hill Country with its vineyards, cultural festivals, and outdoor adventures. Whether you enjoy hiking, wine tasting, or simply relaxing in the peaceful countryside, Belle Oaks is the ideal place to call home. Use the provided plans or design and build the home you've always envisioned, with the freedom to choose your builder and architectural style. Create your private oasis that takes full advantage of the natural surroundings and captures the essence of Hill Country living. Also available with single family home built for under a million - see MLS listing 1751884

# COMMUNITY INFORMATION

Address:LOT 11 - 616 Rosemary Ridge  
Bulverde, TX 78163

County:Comal

City:Bulverde



Subdivision:BELLE OAKS RANCH  
Zip Code:78163

# SCHOOL INFORMATION

School System:Comal  
High School:Smithson Valley  
Middle School:Spring Branch  
Elementary School:Rahe Bulverde Elementary

# PROPERTY FEATURES

Lot Size:1 Acres  
Lot Improvements:Paved Roads  
Location:Hill Country View,Country View,Level  
Restrictions:No Mobile Homes,Cannot be  
Subdivided,Other  
Trees:Many  
Site/Area Features:Clubhouse,Tennis  
Courts,Playground/Park,Neighborhood Pool  
Topography:Level  
Utilities on Site:Water on Site,Natural  
Gas,Electric  
Frontage:Private Street

# TAX AND FINANCIAL INFO

Proposed Terms:Conventional,1st Seller  
Carry,Texas Vet,Wraparound,Cash,Investors OK  
Total Tax:2500



©2024 San Antonio board of REALTORS®. - Certain information contained herein is derived from information which is the licensed property of, and copyrighted by, San Antonio board of REALTORS®. Listing #1722398 Courtesy of Resident Realty, LTD





# PROPERTIES YOU MAY BE INTERESTED IN

---

*Sutton County, TX \$28,950,00011610.00 Acres*

---

*Blanco County, TX \$21,500,000844.00 Acres*

---

*Real County, TX \$19,950,0004365.00 Acres*

---

*Frio County, TX \$18,800,0002373.00 Acres*

# FREE PROPERTY EVALUATION

Name

 First

Phone

Email

County

[Get Your Free Evaluation »](#)

Δ







SABOR.com  
SAN ANTONIO BOARD OF REALTORS







This Business is Regulated by the  
Texas Real Estate Commission

**CALL**



